

INBOARD

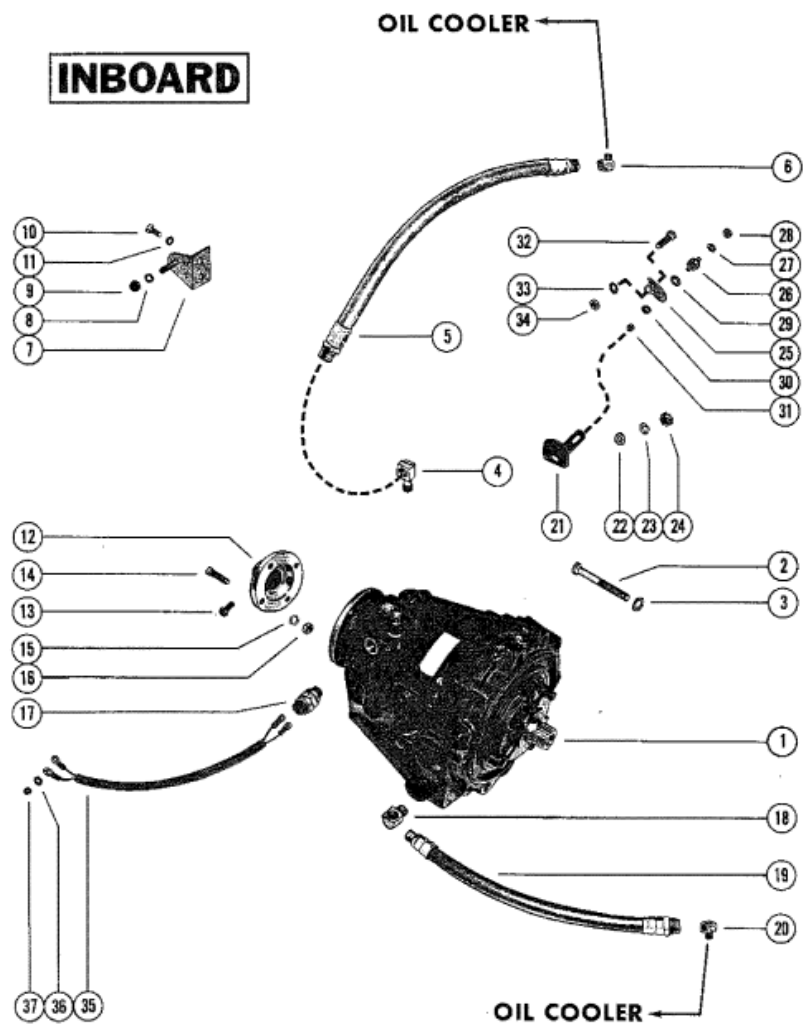

| Parts List | | | | | | |
|------------|-------|--------|-------------------------------|-----|------------------|----------|
| Ref | Class | Part | Description | Qty | Comment | Footnote |
| 1 | | 47810 | TRANSMISSION (DIRECT DRIVE) | 1 | | |
| 1 | | 47811 | TRANSMISSION (1.523:1 REDUC | 1 | | |
| 1 | | 47812 | TRANSMISSION (1.909:1 REDUCTI | 1 | | |
| 1 | | 47813 | TRANSMISSION (2.57:1 REDUCT | 1 | | |
| 1 | | 47814 | TRANSMISSION (2.909:1 REDUC | 1 | | |
| 2 | 10 | 60179 | SCREW, TRANSMISSION TO EN | 6 | | |
| 3 | 13 | 32993 | LOCKWASHER, TRANSMISSION | 6 | | |
| 4 | 22 | 63824 | ELBOW, HOSE TO TRANSMISSI | 1 | | |
| 5 | 32 | 47516 | HOSE, TRANSMISSION TO OIL C | 1 | | |
| 6 | 22 | 47629 | ELBOW, HOSE TO OIL COOLER | 1 | | |
| 7 | | 63815A | 2 BRACKET ASSEMBLY, SHIFT CA | 1 | | |
| 8 | 12 | 56681 | WASHER, SHIFT CABLE STUD | 1 | | |
| 9 | 11 | 46438 | NUT, SHIFT CABLE STUD | 1 | | |
| 10 | 10 | 35585 | SCREW, BRACKET TO FLYWHEE | 2 | | |
| 11 | 13 | 26992 | LOCKWASHER, BRACKET SCREW | 2 | | |
| 12 | | 48386A | 1 FLANGE ASSEMBLY (1") | OPT | | |
| 12 | | 48387A | 1 FLANGE ASSEMBLY (1 1/8") | OPT | | |
| 12 | | 48388A | 1 FLANGE ASSEMBLY (1 1/4") | OPT | | |
| 12 | | 48389A | 1 FLANGE ASSEMBLY (1 3/8") | OPT | | |
| 12 | | 48390A | 1 FLANGE ASSEMBLY (1 1/2") | OPT | | |
| 12 | | 57295A | 1 FLANGE ASSEMBLY (1 3/4") | OPT | | |
| 12 | | 57296A | 1 FLANGE ASSEMBLY (2") | OPT | | |
| 13 | 10 | 60171 | SCREW, FLANGE TO PROPELL | 2 | - SEE NOTE BELOW | |
| 13 | 10 | 60170 | SCREW, FLANGE TO PROPELL | 2 | - SEE NOTE BELOW | |
| 13 | 10 | 60169 | SCREW, FLANGE TO PROPELL | 2 | - SEE NOTE BELOW | |
| 14 | 10 | 60106 | SCREW, TRANSMISSION FLAN | 4 | | |
| 15 | 13 | 32993 | LOCKWASHER, FLANGE SCREW | 4 | | |
| 16 | 11 | 22024 | NUT, FLANGE SCREW | 4 | | |
| 17 | | 47613 | SWITCH, NRUTRAL SAFETY | 1 | | |
| 18 | 22 | 63835 | ELBOW, HOSE TO TRANSMISSI | 1 | | |
| 19 | 32 | 47516 | 2 HOSE, OIL COOLER TO TRANSM | 1 | | |
| 20 | 22 | 47629 | ELBOW, HOSE TO OIL COOLER | 1 | | |
| 21 | | 48515 | LEVER, SHIFT - TRANSMISSION | 1 | | |
| 22 | 12 | 20722 | WASHER, SHIFT LEVER TO TRA | 1 | | |
| 23 | 13 | 26993 | LOCKWASHER, SHIFT LEVER TC | 1 | | |
| 24 | 11 | 20083 | NUT, SHIFT LEVER TO TRANSMI | 1 | | |
| 25 | | 48652 | ADAPTOR, SHIFT CABLE TO SHII | 1 | | |
| 26 | 16 | 48680 | STUD, SHIFT CABLE ADAPTOR | 1 | | |
| 27 | 12 | 20533 | WASHER, ADAPTOR STUD | 1 | | |
| 28 | 11 | 46887 | NUT, ADAPTOR STUD | 1 | | |
| 29 | 12 | 28402 | WASHER, ADAPTOR STUD | 1 | | |